

PW-PSH4-01 Thermal Printer



**Achieve Lower TCO
with a Smart Choice**

NEC's compact thermal receipt printer adds further value to the TWINPOS G Series. You can easily take advantage of its high performance to enhance sales throughput and significantly reduce TCO with its simple serviceability.



PW-PSH4-01 Thermal Printer

Compatibility

The serial port emulator and ESC/POS™ emulator allow easy replacement of legacy printers.

Lower TCO

The affordable price, lower power consumption, and small footprint cut down your TCO.

Serviceability

A drop-in paper roll, small footprint and internal AC adaptor allow easy maintenance and installation. It is the first and only software-driven printer that can be easily updated by third-party remote maintenance software — in remarkably less time than hardware-driven printers. A switch cover is included to prevent unwanted access.

High quality & performance

Fast print speed (maximum 250mm per second), high resolution (203 dpi), a rich number of available fonts, an infinite number of printable image files, and utility software allows you to design high-quality receipts and coupons that boost your sales and customer services.

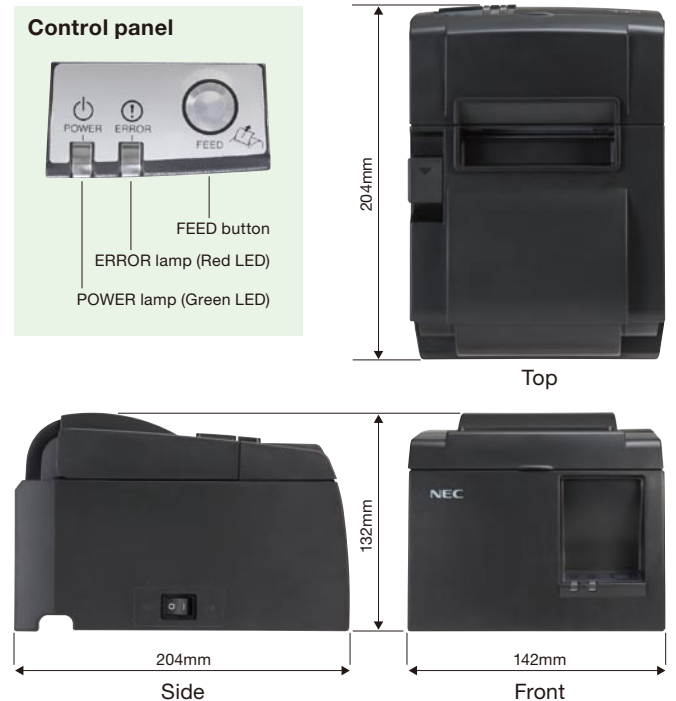

Feature	Specifications
Print speed	250mm/s (maximum)
Print resolution	203 dpi (8 dots per mm)
Number of columns	58mm paper: Maximum 45(Star Line) or 40 (ESC/POS™), 80mm paper: Maximum 64(Star Line) or 56 (ESC/POS™)
Character set	ANK 96, International 16, Graphic 128, plus Japanese, Korean, Simplified and Traditional Chinese
International code pages	Star Line: 40 + 1, ESC/POS™: 10 + 1 allowing an additional character page to be added as using command.
Connectivity	TWINPOS G5, TWINPOS G7
Paper specifications	Width: 80mm or 58mm (with guide attached), Roll diameter: max 83mm, Paper thickness: 0.065~0.085mm
Available drivers	OPOST™, JavaPOS™, Windows driver
Supported OS	Windows® 7 (32 bit), Windows® XP (32 bit), Windows® Embedded POSReady 2009
Interface / port	USB 2.0 Full Speed with cable supplied
Emulation	Star Line mode or ESC/POS™ mode*
Power supply	Internal
Dimensions (WxDxH)	142 x 204 x 132 mm (5.59 x 8.03 x 5.20 inch)
Weight	Approximately 1.7kg
Accessories included	58mm paper guide, USB cable, switch cover and thermal paper roll

* NEC makes no claims or guarantees regarding the compatibility of the ESC/POS emulator with Epson ESC/POS™ mode.

- Features and specifications are subject to change without notice.
- Microsoft Windows and the Windows logo are trademarks or registered trademarks of Microsoft Corporation in the United States and other countries.
- The colors of products shown in this brochure may vary from actual product colors due to printing conditions.
- When exporting this product, follow necessary procedures such as application for export permits from the Japanese government, as stipulated in the Foreign Exchange and Foreign Trade Control Law. Also, follow required procedures for applicable U.S. Export Administration Regulations or other foreign government regulations.

⚠ Notes on Safety

Please carefully read documents enclosed with the products to ensure proper use.

Do not install in locations where high amounts of water, humidity, dust, or oil smoke are present. Doing so may cause a fire, breakdown or electric shock.

NEC Infrontia Corporation

